

COMPLIANCE

Our low-pressure system with flexible pipes, controlled rate emitters and plastic membrane uses the most recent technology which is far superior to other Reticulation Systems. Most Altis materials are made in Australia. We do not import cheap overseas pipe, as chemicals for the pipe manufacture are specially blended for Altis Termite Reticulation System.

We have a CodeMark certificate of conformity for the following BCA clauses:

1. Volume One: BP1.1 and BP1.2 (limited only to actions by subterranean termites)
2. Volume Two: P2.1 (limited only to actions by subterranean termites)
3. State Additions: Volume Two: QLD P2.1.1 (limited only to actions by subterranean termites)

CodeMark compliance is a requirement of the Building Code of Australia for new construction.

The CodeMark certificate is available from www.altis.net.au

Engineer reports show that the flexible pipes bend but will not break if subjected to soil movement, a common problem in clay soils. The perforated plastic membrane will prevent excess addition of water to clay, and the Altis System can use one third of the normal water used to deliver chemicals. (Water simply adds to clay movement). The emitters do not allow foreign materials in or out of the pipes.

Where a clay site has only a minimum sand bed, Altis will still deliver chemicals evenly and effectively.

Certificate Number
SAIG-07-CM20007



PROTECTING AUSTRALIAN HOMES SINCE 1995

Altis 
TERMITE RETICULATION SYSTEM

COST EFFECTIVE

Altis is the clear leader. It is the only system which can:

- Utilise multiple lines from one pump up point without the need to balance. (Saves time in calculation and prior planning and eliminates possibility of error).
- Be run 50 metres from a single take off point. (Reduces time for pump up of other single systems versus the Altis multiple system).
- Deliver chemical to satisfy the Australian Standard of 100L/m³ (External perimeter footings 50mm below surface). (All other systems require in excess of 3 times that amount thus reducing chemical cost and protecting the environment).
- Be easily tailor made to suit multiple pre and post construction situations. (3 underslab and 2 external systems) make it easy to make a system to suit your needs.

It is simple and non intrusive to recharge an Altis System. This adds up to a substantial net saving in the long term and makes Altis a true investment, not a cost.

Drilling holes internally damages the builder's moisture barrier and creates further access to termites in the future. External trenches may also be needed and paving lifted and in extreme cases concrete may need to be cut.

A pre installed Altis System means that intrusion would be unnecessary. This is a substantial saving in costs and no intrusion by drilling or trenching.

Spread over the 50 year life of a system the cost is less than \$3.00 per week for a typical home. An Altis system is the most cost effective insurance.

HOW DO I BECOME AN ALTIS ACCREDITED INSTALLER?

Looking for an opportunity to grow your business through additional product offerings and long term service arrangements? Become an accredited Altis installer today! Simply complete the attached registration form (or go online at www.altis.net.au and download the form) and return it to Altis.

RETREATMENTS

An Altis System avoids the cost of expensive retreatment including drilling and retrenching which is necessary when the handspraying method is used, this is a process that may be repeated.

50 YEAR PROTECTION & REPLENISHABLE



using the altis termite
reticulation system



CONTACT US

T: 07 3349 9274
F: 07 3849 7980
E: info@altis.net.au
PO Box 961, Sunnybank
Queensland. 4109

www.altis.net.au

SIMPLY THE BEST

WHAT IS ALTIS

It is a patented Reticulation System designed to effectively treat the area under concrete slabs, for protection against infestation by subterranean termites and around the external perimeter of structures to prevent termites entering from the outside of a building. Altis is installed prior to laying of the concrete slab for the internal system and externally after external work has been completed but prior to any concreting, paving etc. Chemicals are added after the concrete slab has dried and so does not expose occupants to chemicals.

SIMPLE EXTERNAL PERIMETER



EFFECTIVE TESTED PLUMBING PENETRATIONS FULL UNDERSLAB



PROVEN INTERNAL PERIMETER



WHAT IS DIFFERENT ABOUT ALTIS

The Altis System is one of the only Reticulation Systems that uses flexible pipes, which have emitters fabricated into it at the time of manufacture. Emitters are the heart of the system and these act as back flow preventers/filters and are scientifically graduated to flow at a specific rate. The Emitters are located every 175mm along the length of the pipe which is at least double the recommended minimum needed to accurately deliver and spread chemicals.



the emitter

This is of particular advantage in difficult areas such as clay sites, uneven sand pads and step-downs and where there is height difference. It is the **ONLY LOW PRESSURE SYSTEM**.

Because of the "even flow" it is not necessary to balance each line in the system against other lines. A further benefit is that each line can be run for up to **50 METRES**, making it possible to treat the entire circumference of most structures from one pump up point.

- Emitters ensure no grit, roots from vegetation, or other forms of intrusion will clog the pipe and render it ineffective.

- The unique, patented difference is that the pipes are laid over a perforated plastic membrane, beneath the builder's membrane. This is another reason why chemical is distributed evenly and reduces the risk of any area being untreated.
- Pipes are different, coloured purple to make them stand out on site, resistant to solvents, are high density for long life and to give them flexibility in undulating situations.
- The pipe won't crush under the weight of concrete. It can't as it starts life off flat and is designed to be slightly elastic so that on filling it rounds up to about the size of a garden hose and by doing so pushes the soil below aside.

ANNUAL INSPECTIONS

A condition of the Altis warranty is annual inspection with retreatment if required. The Australian Standard 3660.1-2000 recommends that maintenance be carried out within 3 months of completion of the building and then not less than every twelve months thereafter. The primary purpose of the yearly inspection is to ensure breaches of the chemical barrier have not occurred. Altis Systems are installed by Altis trained and accredited persons.

The Pest Management Company that is licensed to install Altis is responsible for installation and to use the chemicals injected according to the chemical supplier's label. As part of the yearly maintenance an Altis licensed installer can offer the retreatment of the system on a more regular basis to ensure peace of mind.



ALTIS PREMIUM FULL UNDERSLAB SYSTEM

With the Altis Premium Full Underslab System and an Altis External Perimeter System every corner is protected.

Even a slab built to Australian Standard 2870 can crack enough to produce a 1.3mm opening. This is sufficient for subterranean termites to enter and disperse undetected.

There is a misconception that most attacks start on the outside of a construction. In fact many attacks are under the slab, and full protection is the best insurance.

Pipes are spread 300mm or 450mm apart on perforated plastic sheet over the entire area of the slab. The Altis Premium System incorporates an Altis External Perimeter treatment to provide the best possible protection. No other system contains this huge safety margin.

ALTIS INTERNAL PERIMETER SYSTEM

The Altis Internal Perimeter System covers both the internal perimeters of the building as well as service penetrations through the concrete slab.

This system can only be used when the slab is constructed in accordance with Australian Standard 2870. It consists of a 600mm wide perforated sheet with 2 dripper lines or the economy system of 300mm wide perforated sheet with 1 dripper line.

Any slab penetrations must also be linked to the system.

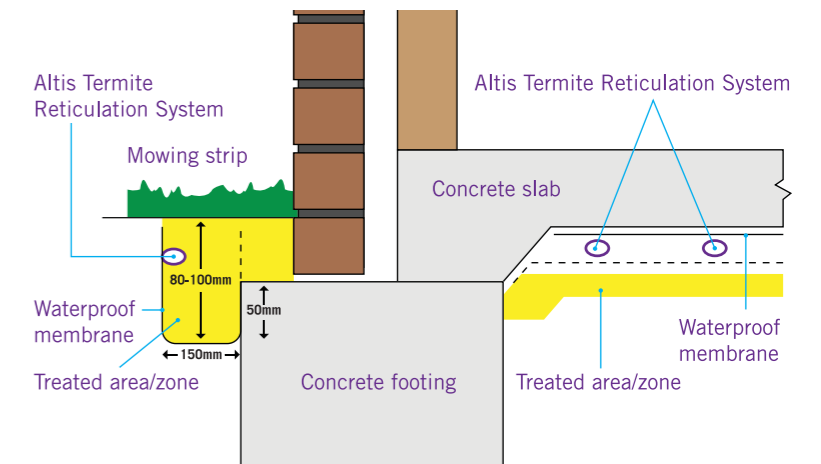

ALTIS EXTERNAL PERIMETER SYSTEM

Perimeter systems will vary according to soil type and construction method. The Altis Systems can be adapted to requirements.

There are two products which can be used to meet the requirements to provide a complete external barrier.

The two products are the 150mm wide perforated sheet with one dripper line and the 300mm unperforated sheet also with one dripper line. These two products can be used singularly or in combination.

You as an accredited Altis installer can advise on what best suits each situation.

